

7UHQFK 026 %DUULHU 6FKRWWN\ 5H

Features

- Advanced trench technology
- Low forward voltage drop
- Low power losses
- High efficiency operation
- Lead Free Finish, RoHS Compliant

Applications

- DC/DC Converters
- AC/DC Adaptors
- Switching Power Supplies
- Freewheeling Diodes

Maximum ratings and electrical characteristics (TJ = 25°C unless otherwise noted)

Parameter	Symbol	Limit	Unit
Maximum repetitive peak reverse voltage	VRRM		V
Maximum average forward rectified current	IF(AV)		A
Peak forward surge current 8.3 ms single half sine- wave superimposed on rated load per diode	IFSM	60	A
Operating junction and storage temperature range	TJ, TSTG	WR	°C
7\SLFDO WKHUPDO UHVLVWDQFH SHU GLSRGH ORXQWHG RQ)5	3 & CAW		
Instantaneous forward voltage per diode	VF(1)	7 < 3	0 \$;
		IF= A	TJ=25°C
		IF= A	TJ=125°C
Instantaneous reverse current per diode at rated reverse voltage	IR(2)	TJ=25°C	X \$
		TJ=125°C	mA

Notes:

3XOVH WHVW 3XOVH ZLGWK GXW\ F\FOH
 3XOVH WHVW 3XOVH ZLGWK 0

RATINGS AND CHARACTERISTICS CURVES (TA = 25 °C unless otherwise noted)

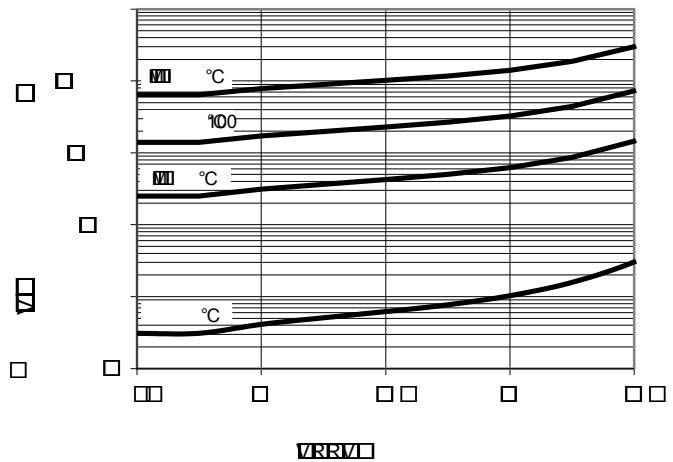
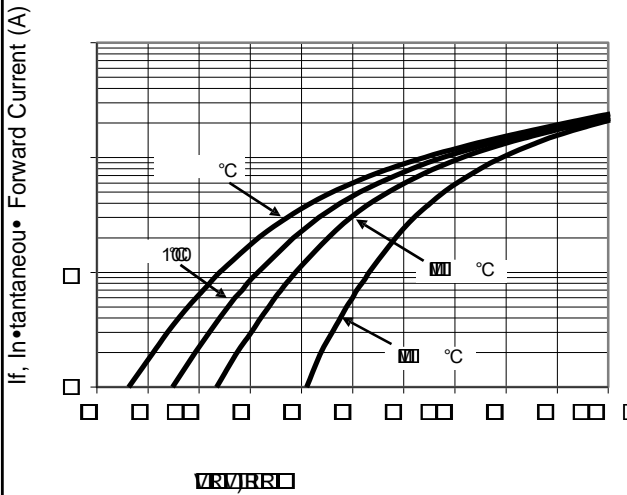
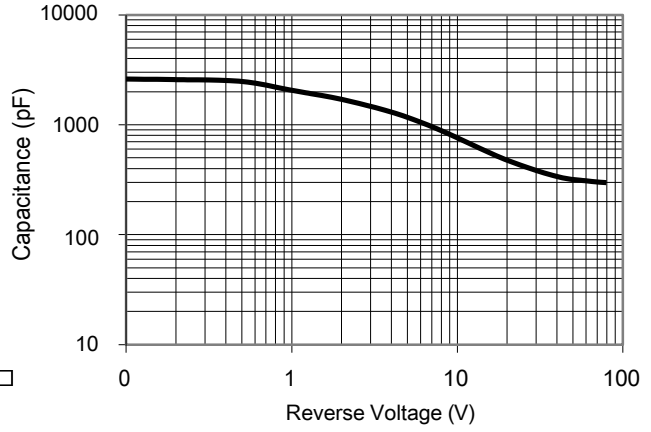
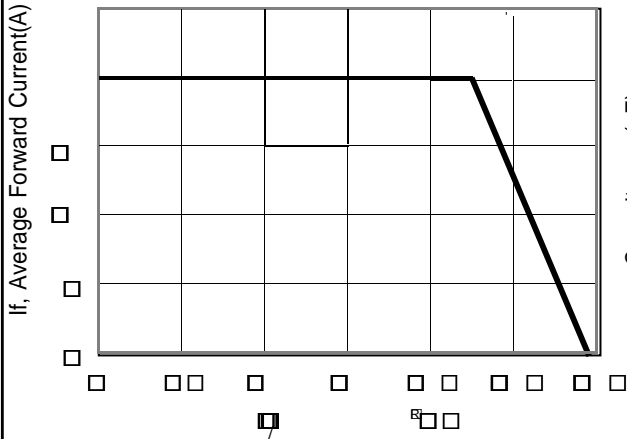

PACKAGE OUTLINE DIMENSIONS

TO-277

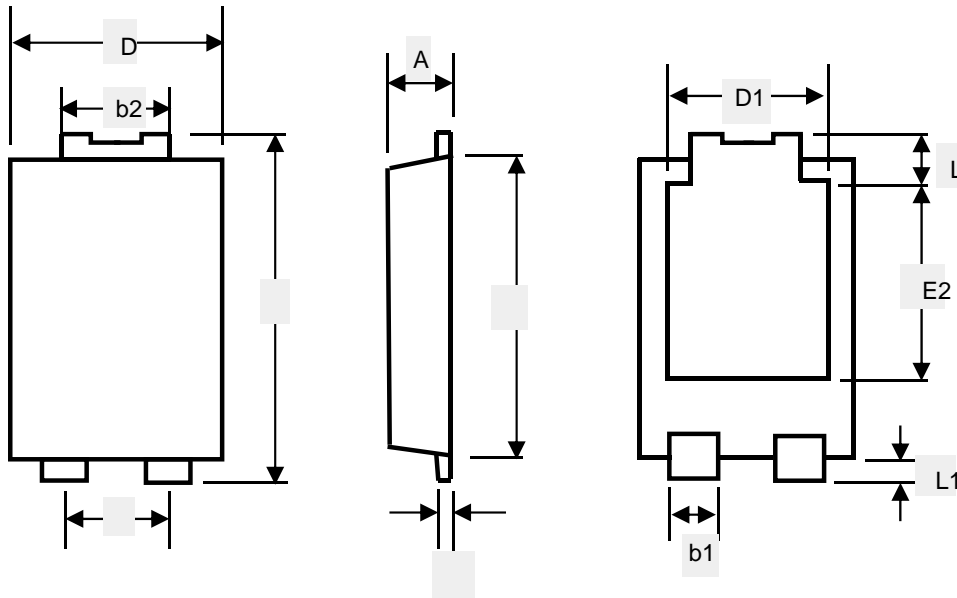

TO-277 Mechanical Data

UNIT	A
------	---

TO-277 Suggested Pad Layout

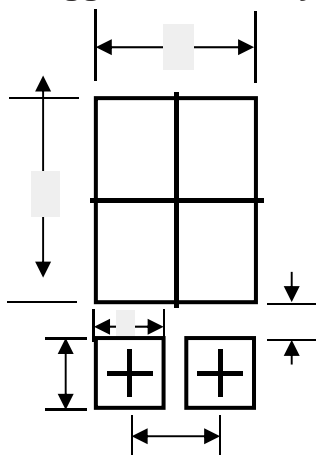

UNIT							
mm	min	. 0	. 0	.			
mil	min				35.43		

Marking Information

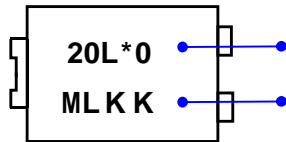

Product model :TSP20L 0

Referred to as 20L 0

PDC information

Y X WW

WW:Week code(01 to 53)

X:Internal identification code

Y:Year code(ex:0=2020)

Packaging Information

1.Reel Dimensions

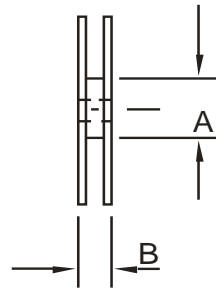
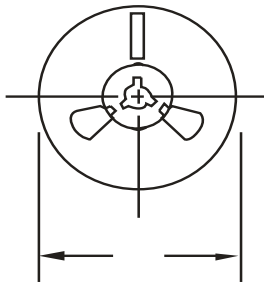

2. Inside Box

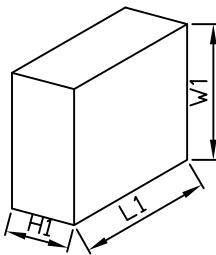

3. Outside Box

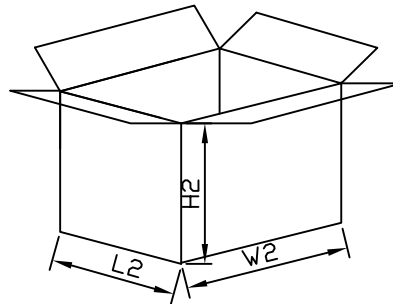

Packaging Information

NO	UNIT	Reel Dimensions			Inside Box			Outside Box		
		A	B		L1	W1	H1	L2	W2	H2
Size	mm	330	70	15	335	335	43	360	360	360
QTY	PCS	Smallest package,5000PCS/reel			10,000PCS,2 reel in total			80,000PCS/carton, boxes in total		
Note	Tolerance 20mm,±3mm; 21-100mm,±5mm; 101-500mm,±10mm									