

7UHQFK 026 %DUULHU 6FKRWWN\ 5H

Features

- ‡ \$GYDQWUHQFK WHFKQRORJ\
- ‡ /RZRUZDWRGWDJH GURS
- ‡ /RZRZWRVVHV
- ‡ +LJHILFLHQF\ RSHUDWLRO
- ‡ /HDGHHLQLVK &RPSOLDQW

763 / \$)

SMAF

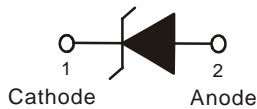

Applications

- ‡ '&' & RQYHUWHUV
- ‡ \$&' & GDSWRUV
- ‡ 6ZLWFKRZHSXSSOLHV
- ‡)UHHZKHHLRGLJ

Maximum ratings and electrical characteristics (T_J = 25°C unless otherwise noted)

3DUDPHWHU		6\PERO	/LPLW	8QLW	
0D[LPLXPHSHVSHUNYHYURQHW DJH		9550		9	
0D[LPLXPHYHURJHZDUG UFKJWHIQWG		,) \$9		\$	
3HDN IRVZDUEBUUHQW VLQDQH ZDYH VXSHULPSRVHGRFSGUDRCHG		,)60		\$	
2SHUDMXQDQWRWRUDJH WHPSHUDW		X0H 060JH	WR	f&	
7\SLFDO WKHUPDO UHVLVWDQFH SHU ORXQWHG RQ)5 3&%		GLRGH 5\$-&		f& :	
,QVWDQWDQHRXV IRUZDUGS YRQWDJH		9)	7<3	0\$;	
	,) \$		7- f&		9
,QVWDQWDQHRXV UHVRUWH UDWHYHYURQHW DJH	7- f&	,5		X\$	
	7- f&			P\$	

1RWHV

3XOVH WHVVSXOVH ZLGWK GXW\F\FOH

3XOVH WHVW 3XOVH ZLGWK 0

RATINGS AND CHARACTERISTICS CURVES

7\$

f & XQOHVQRWKB UZLVH

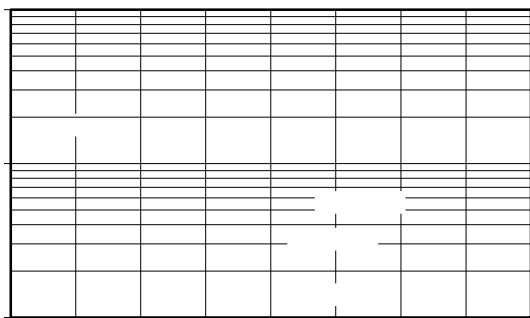
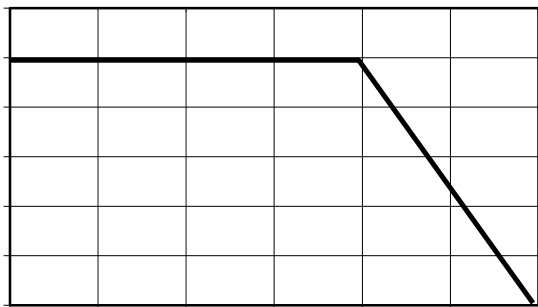

0DUNLQJ ,QIRUPDWLRQ

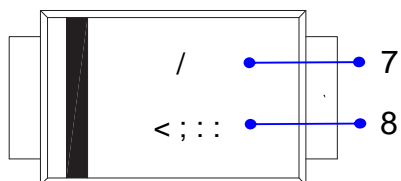

7 3URGXFW 763 GH (\$) LV DEEUHYLDWHG W
8 3' & LQIRUPDWLRQ



3DFNDJLQJ ,QIRUPDWLRQ

5HHO 'LPHQVLRQV

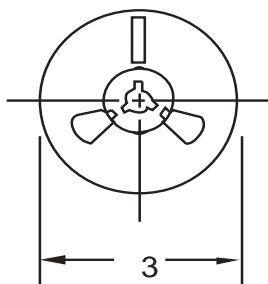

,QVLGH %R[

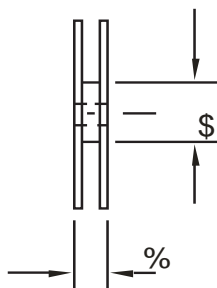

2XWVLGH %R[

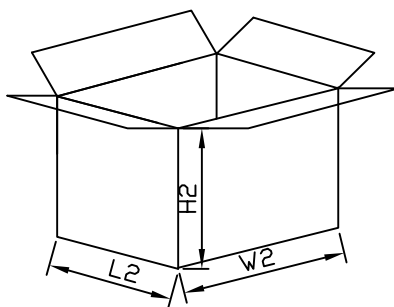
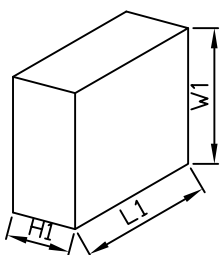

3DFNDJLQJ ,QIRUPDWLRQ

12	81,7	5HHO 'LPHQVLRQV	,QVLGH	2XWVLGH %R[
----	------	-----------------	--------	-------------

& \$ % / : + / : +

6L]H PP

4 Žďpíó 6y'í`