

7UHQFK 026 %DUULHU 6FKRWWN\ 5H

d^Wîi>òì  
!"

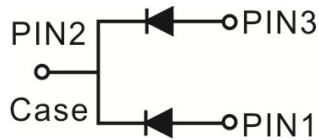
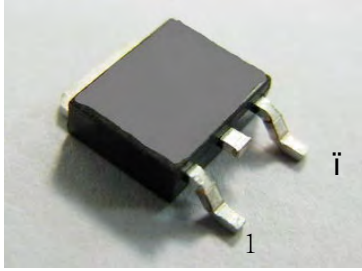

Features

- ‡ \$GYDQWUHQFK WHFKQRORJ\
- ‡ /RZRUZDWRGWDJH GURS
- ‡ /RZRZDWRVHV
- ‡ +LJHILFLHQF\ RSHUDWLRO
- ‡ /HDGH)HLQLVK &R#6OLDQW

Applications

- ‡ '&' & RQYHUWHUV
- ‡ \$&' & \$GDSWRUV
- ‡ 6ZLWFKRZDSSOLHV
- ‡ )UHHZKHHLRGLJ

Maximum ratings and electrical characteristics (T<sub>J</sub> = 25°C unless otherwise noted)

3DUDPHWHU		6\PERO	/LPLW	8QLW
0D[LPXPHSHVSHUNYHYURQHW DJH		9550		9
0D[LPXPHYHURJH ZDUG UFKUWHIHWG	GHYLFH SHGLRGH	,) \$9		\$
3HDN IRVZDWRUHQW VLKDDHQH ZDYH VXSHULPSRVHGRFSDUDRWHG		,)60		\$
2SHUDMXQDQGRQWRUDJH WHPSHUDW		XUH76D*QJH	WR	f&
7\SLFVCHUPDO USHVULVQHDQFH	72	5\$-&		f& :
,QVWDQWDQHRROWRUJZDUG SHGLRGH		9)	7<3	0\$;
	,) \$		7- f&	9
	,) \$		7- f&	
	,) \$		7- f&	
,QVWDQWDQHRXUUSHQWRUWH UDWHYHYURQHW DJH	7- f&	,5		
	7- f&			P\$

1RWHV

3XOVH WHVVSXOVH ZLGWK GXW\F\FOH

3XOVH WHVW 3XOPH ZLGWK 0

# RATINGS AND CHARACTERISTICS CURVES 7\$

3 32:(5',66,3\$7,21 :

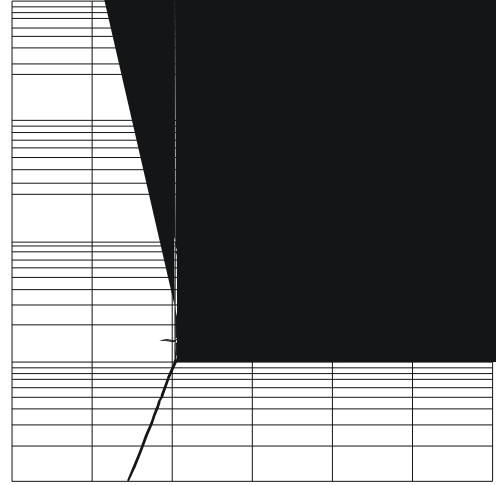
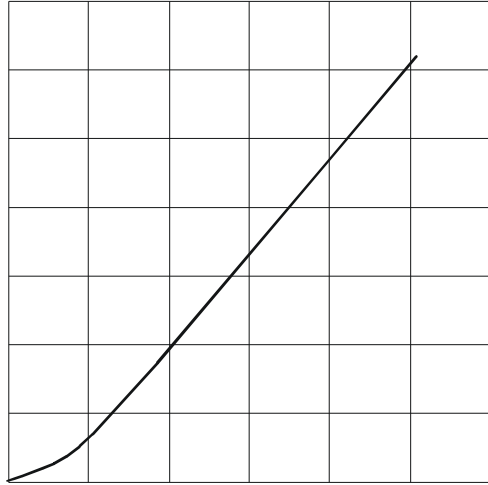

) \$9 \$9(5\$\*( )25:\$5' &855(17 \$  
)LJXUH )RUZDUG 3RZHU 'LVVLSDWLRQ

PACKAGE OUTLINE DIMENSIONS

1 R W H X Q L W , Q P P

0DUNLQJ ,QIRUPDWLRQ

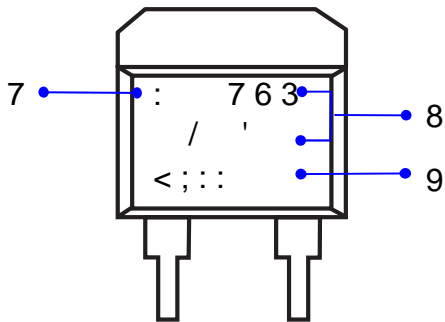

7 : &RPSDQ\ V WUDGHPDUN  
8 3URGXFW PRGHO 763 / '  
9 3'& LQIRUPDWLRQ

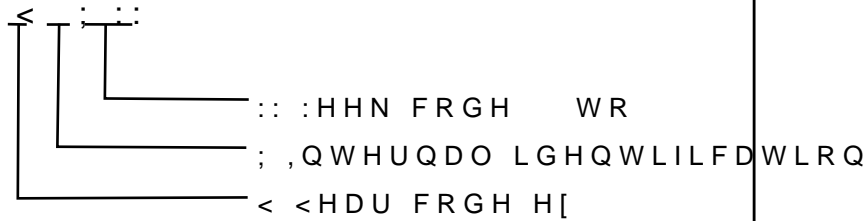

3DFNDJLQJ ,QIRUPDWLRQ

5HHO 'LPHQVLRQV

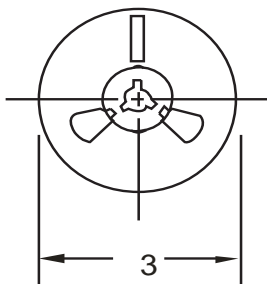

,QVLGH %R[

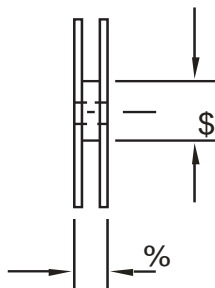

2XWVLGH %R[

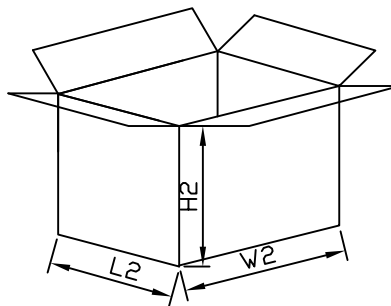
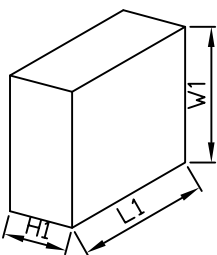

3DFNDJLQJ ,QIRUPDWLRQ

12	81,7	5HHO 'LPHQVLRQV			,QVLGH %R[			2XWVLGH %R[		
6L]H	PP	&	\$	%	/	:	+	/	:	+
47<	3&6 6PDO	3&6 6PDO	3&6 UHHO	3&6 UHHO	3&6 UHHO	3&6 UHHO	3&6 UHHO	3&6 UHHO	3&6 UHHO	3&6 UHHO
1RWH		7ROHUDQFPP" PP			PP" PP			PP" PP		